

ENVIRONMENTAL IMPACT ASSESSMENT ORDINANCE
(CHAPTER 499)
Sections 10 & 12

環境影響評估條例
(第499章)
第10及12條

FURTHER ENVIRONMENTAL PERMIT TO CONSTRUCT
A DESIGNATED PROJECT

建造指定工程項目的新的環境許可證

PART A (MAIN PERMIT)

A部 (許可證主要部分)

Pursuant to Sections 10 and 12 of the Environmental Impact Assessment Ordinance (EIAO), the Director of Environmental Protection (the Director) grants this further environmental permit to China State - Leader Joint Venture (China State Construction Engineering (Hong Kong) Limited and Leader Civil Engineering Corp. Ltd as partner) (hereinafter referred to as the "Permit Holder") to construct the designated project described in Part B subject to the conditions specified in Part C. The issue of this further environmental permit is based on the documents, approvals or permissions described below:

根據《環境影響評估條例》(環評條例)第10條及12條的規定，環境保護署署長(署長)將本新的環境許可證批予中國建築 - 利達聯營(中國建築工程(香港)有限公司及利達土木工程有限公司為合伙人)(下稱“許可證持有人”)，以建造B部所說明的指定工程項目，但須遵守C部所列明的條件。本新的環境許可證是依據下列文件、批准或許可而簽發：

Application No. 申請書編號	FEP-144/2013
Document in the Register : 登記冊上的文件:	<ol style="list-style-type: none">1. Central - Wan Chai Bypass and Island Eastern Corridor Link (Register No.: AEIAR-041/2001)<ul style="list-style-type: none">- Environmental Impact Assessment Report (July 2001) [Hereinafter referred to as "the CWB&IECL EIA Report"]- Environmental Monitoring and Audit Manual- Executive Summary2. The Director's letter of approval of the CWB&IECL EIA Report dated 31 August 2001 referenced (19) in Ax(2) to EP2/H4/A/10 II.3. Wan Chai Development Phase II and Central-Wan Chai Bypass (Register No.: AEIAR-125/2008)<ul style="list-style-type: none">- Environmental Impact Assessment Report (December 2007) [Hereinafter referred to as "the WDII&CWB EIA Report"]- Environmental Monitoring and Audit Manual- Executive Summary- Further information received from the Civil Engineering and Development Department on 11 March 2008, 9 April 2008 and 14 November 2008 under Section 8(1) of the Environmental Impact Assessment Ordinance4. The Director's letter of approval of the WDII&CWB EIA Report dated 11 December 2008 referenced (85) in EP2/H4/S3/15 Pt.2.5. Central Reclamation Phase III - Studies, Site Investigation, Design and

	<p>Construction (Register No.: AEIAR-040/2001)</p> <ul style="list-style-type: none">- Environmental Impact Assessment Report (July 2001) [Hereinafter referred to as "the CRIII EIA Report"]- Environmental Monitoring and Audit Manual- Executive Summary <p>6. The Director's letter of approval of the CRIII EIA Report dated 31 August 2001 referenced (19) in Ax(4) to EP2/H4/C/09 II.</p> <p>7. Environmental Permit Issued – Permit No.: EP-356/2009 issued to Civil Engineering and Development Department on 30 July 2009 for construction of the following designated projects:</p> <ul style="list-style-type: none">(i) Permanent and temporary reclamation works including associated dredging works in Wan Chai Development Phase II (WDII) area (referred to as "DP3" in the WDII&CWB EIA Report);(ii) Wan Chai East Sewage Outfall (referred to as "DP5" in the WDII&CWB EIA Report); and(iii) Dredging for the Cross-harbour Water Mains from Wan Chai to Tsim Sha Tsui (referred to as "DP6" in the WDII&CWB EIA Report). <p>8. Application for Environmental Permit and attachments submitted by the Permit Holder on 27 July 2009 (Application No.: AEP-364/2009)</p> <p>9. Environmental Permit (No. EP-364/2009) issued on 17 August 2009</p> <p>10. Application documents for Variation of Environmental Permit including all attachments submitted by the Permit Holder on 28 July 2010 (Application No. VEP-321/2010)</p> <p>11. Environmental Permit issued – Permit No.: EP-364/2009/A issued on 4 August 2010.</p> <p>12. Application documents for Variation of Environmental Permit including all attachments submitted by the Permit Holder on 31 August 2012 (Application No. VEP-374/2012)</p> <p>13. Environmental Permit issued – Permit No.: EP-364/2009/B issued on 20 September 2012</p> <p>14. Application for Further Environmental Permit including all attachments submitted on 8 February 2013 (Application No.: FEP-144/2013).</p> <p>1. 中環及灣仔繞道和東區走廊連接路設計及建築工程 (登記冊編號: AEIAR-041/2001)</p> <ul style="list-style-type: none">- 環境影響評估報告 (2001年7月) [下稱「CWB&IECL環評報告」]- 環境監察審核手冊- 行政摘要 <p>2. 署長於2001年8月31日發出CWB&IECL環評報告的批准信, 檔案編號: (19) in Ax(2) to EP2/H4/A/10 II</p> <p>3. 灣仔發展計劃第二期及中環灣仔繞道 (登記冊編號: AEIAR-125/2008)</p> <ul style="list-style-type: none">• 環境影響評估報告 (2007年12月) [下稱「WDII&CWB環評報告」]• 環境監察審核手冊• 行政摘要
--	---



	<ul style="list-style-type: none">• 土木工程拓展署根據條例第8.(1)條於2008年3月11日、2008年4月9日及2008年11月14日所提交的進一步資料 <ol style="list-style-type: none">4. 署長於2008年12月11日發出批准WDII&CWB環評報告的信件，檔案編號：(85) in EP2/H4/S3/15 Pt. 25. 中環填海計劃第III期 - 研究、實地堪測、設計與建築(登記冊編號: AEIAR-040/2001)<ul style="list-style-type: none">• 環境影響評估報告 (2001年7月)[下稱「CRIII環評報告」]• 環境監察審核手冊• 行政摘要6. 署長於2001年8月31日發出CRIII環評報告的批准信，檔案編號：(19) in Ax(4) to EP2/H4/C/09 II7. 已簽發的環境許可證- 許可證編號EP-356/2009; 於2009年7月30日簽發與土木工程拓展署以建造以下指定工程項目:<ol style="list-style-type: none">(i) 在灣仔發展計劃第二期的永久及臨時填海工程(包括相聯挖泥工程)(WDII&CWB環評報告內稱“DP3”)(ii) 灣仔東污水排水口(WDII&CWB環評報告內稱“DP5”);及(iii) 灣仔至尖沙咀海底輸水管的挖泥工程(WDII&CWB環評報告內稱“DP6”)。8. 許可證持有人於2009年7月27日提交的環境許可證申請文件及附件(申請書編號：AEP-364/2009)9. 已簽發的環境許可證 (編號：EP-364/2009) 於2009年8月17日簽發10. 許可證持有人於2010年7月28日提交的更改環境許可證申請文件包括所有附件(申請書編號：VEP-321/2010)11. 已簽發的環境許可證 - 許可證編號：EP-364/2009/A 於2010年8月4日簽發。12. 許可證持有人於2012年8月31日提交的更改環境許可證申請文件包括所有附件(申請書編號：VEP-374/2012)13. 已簽發的環境許可證 - 許可證編號：EP-364/2009/B 於2012年9月20日簽發。14. 於2013年2月8日提交的新的環境許可證申請文件包括所有附件(申請書編號：FEP-144/2013)。
--	---

March 2013
2013年3月5日

Date
日期



(Ken Y.K. Wong)
Principal Environmental Protection Officer
for Director of Environmental Protection
環境保護署署長
(首席環境保護主任 黃耀光 代行)



PART B (DESCRIPTION OF DESIGNATED PROJECT)

B部 (指定工程項目的說明)

Hereunder is the description of the designated project mentioned in Part A of this environmental permit (hereinafter referred to as "the Permit"):

下列為本環境許可證(下稱“許可證”)A部所提述的指定工程項目的說明:

<p>Title of Designated Project 指定工程項目的名稱</p>	<p>Wan Chai Development Phase II – Central – Wan Chai Bypass at Wan Chai West (Contract No. HK/2012/08) – Tunnel Works - as part of the “Central–Wan Chai Bypass including its Road Tunnel and Slip Roads” (the CWB project) which is covered in the Environmental Permit No. EP-364/2009/B (This designated project is hereinafter referred to as “the Project”)</p> <p>灣仔發展第二期 - 中環灣仔繞道 - 灣仔西段 (合約編號 HK/2012/08) - 隧道工程 - 此工程為 “中環灣仔繞道(包括其行車隧道及連接路)” (CWB工程項目)的一部份, 受已簽發的環境許可證 - 許可證編號 : EP-364/2009/B的管制 (本指定工程項目下稱“工程項目”)</p>
<p>Nature of Designated Project 指定工程項目的性質</p>	<p>The Project is a part of the Central-Wan Chai Bypass project. (The CWB project will involve construction of a trunk road and its road tunnel more than 800m length between portals.)</p> <p>此工程項目是中環灣仔繞道工程項目的一部份。(CWB工程項目涉及興建一條主幹道;及其入口之間的長度超過800米的行車隧道。)</p>
<p>Location of Designated Project 指定工程項目的地點</p>	<p>Wan Chai West harbour-front area, Hong Kong The location of the Project is shown in Figures 1a and 1b of this Permit.</p> <p>香港灣仔西海旁。 工程項目的地點展示於本許可證圖1a及圖1b內。</p>
<p>Scale and Scope of Designated Project 指定工程項目的規模和範圍</p>	<p>The scope of the Project mainly includes:</p> <ul style="list-style-type: none"> • construction of a dual three-lane trunk road tunnel of approximately 310m in length (including the substructure of Middle Ventilation Building) and two slip roads ; (part of the CWB project) <p><u>Remarks:</u></p> <ul style="list-style-type: none"> • The permanent and temporary reclamation and associated dredging works related to the CWB construction are separately covered by the environmental permit No. EP-356/2009 issued to the Civil Engineering and Development Department (CEDD). <p>工程項目的範圍主要包括:</p> <ul style="list-style-type: none"> • 建造一條約長310米的三線雙向行車隧道(包括中部通風大樓底部構造)及連接路。 (CWB工程項目的一部份) <p><u>備註:</u></p> <p>中環灣仔繞道相關的永久及臨時填海工程(包括相聯挖泥工程) 已包括在簽發與土木工程拓展署的環境許可證(許可證編號: EP-356/2009)。</p>

EIAO
EPD



PART C (PERMIT CONDITIONS)

1. General Conditions

- 1.1 The Permit Holder and any person working on the Project shall comply with all conditions set out in this Permit. Any non-compliance by any person may constitute a contravention of the Environmental Impact Assessment Ordinance (EIAO) (Cap.499) and may become the subject of appropriate action being taken under the Ordinance.
- 1.2 The Permit Holder shall ensure full compliance with all legislation from time to time in force including, without limitation to, the Air Pollution Control Ordinance (Cap. 311), Water Pollution Control Ordinance (Cap. 358), Noise Control Ordinance (Cap. 400), and Waste Disposal Ordinance (Cap. 354). This Permit does not of itself constitute any ground of defense against any proceedings instituted under any legislation or imply any approval under any legislation.
- 1.3 The Permit Holder shall make copies of this Permit together with all documents referred to in this Permit and the documents referred to in Part A of this Permit readily available at all times for inspection by the Director or his authorized officers at all sites/offices covered by this Permit. Any reference to the Permit shall include all documents referred to in the Permit and also the relevant documents in the Register.
- 1.4 The Permit Holder shall give a copy of this Permit to the person(s) in charge of the site(s) and ensure that such person(s) fully understands all conditions and all requirements incorporated by the Permit. The site(s) refers to site(s) of construction of the Project and shall mean the same hereafter.
- 1.5 The Permit Holder shall display conspicuously a copy of this Permit on the construction site(s) at all vehicular site entrances/exits or at a convenient location for public's information at all times. The Permit Holder shall ensure that the most updated information about the Permit, including any amended Permit, is displayed at such locations. If the Permit Holder surrenders a part or the whole of this Permit, the notice he sends to the Director shall also be displayed at the same locations as the original Permit. The suspended, varied or cancelled Permit shall be removed from display at the construction site(s).
- 1.6 The Permit Holder shall construct the Project in accordance with the project description in Part B of this Permit (hereafter referred to as "the Project").
- 1.7 The Permit Holder shall ensure that the Project is designed and constructed in accordance with the relevant information and recommendations described in the approved CWB&IECL EIA Report (Register No. AEIAR-041/2001), the approved WDII&CWB EIA Report (Register No. AEIAR-125/2008), the approved CRIII EIA Report (Register No. AEIAR-040/2001), the application documents for environmental permit, other relevant documents in the Register, and the information or mitigation measures described in this Permit, and mitigation measures to be recommended in submissions that shall be deposited with or approved by the Director as a result of permit conditions contained in this Permit, and mitigation measures to be recommended under on-going surveillance and monitoring activities during all stages of the Project. Where recommendations referred to in the documents of the Register are not expressly referred to in this Permit, such recommendations are nevertheless to be implemented unless expressly excluded or impliedly amended in this Permit. The Project is part of the CWB project..
- 1.8 All deposited submissions, as required under this Permit, shall be rectified and resubmitted in



accordance with the comments, if any, made by the Director within one month of the receipt of the Director's comments or otherwise specified by the Director.

- 1.9 All submissions approved by the Director, all submissions deposited without comments by the Director, or all submissions rectified in accordance with comments by the Director under this Permit shall be construed as part of the permit conditions described in Part C of this Permit. Any variation of the submissions shall be approved by the Director in writing or as prescribed in the relevant permit conditions. Any non-compliance with the submissions may constitute a contravention of the Environmental Impact Assessment Ordinance (Cap.499). All submissions or any variation of the submissions shall be certified by the Environmental Team (ET) Leader and verified by the Independent Environmental Checker (IEC) employed for the CWB project before submitting to the Director under this permit (see note 7).
- 1.10 The Permit Holder shall release all finalized submissions, as required under this Permit, to the public by depositing copies in the Environmental Impact Assessment Ordinance Register Office, or in any other places, or any internet websites as specified by the Director, or by any other means as specified by the Director for public inspection. For this purpose, the Permit Holder shall provide sufficient copies of the submissions.
- 1.11 All submissions to the Director required under this Permit shall be delivered either in person or by registered mail to the Environmental Impact Assessment Ordinance Register Office (currently at 27/F, Southorn Centre, 130 Hennessy Road, Wanchai, Hong Kong). Electronic copies of all finalized submissions required under this Permit shall be prepared in Hyper Text Markup Language (HTML) (version 4.0 or later) and in Portable Document Format (PDF version 4.0 or later), unless otherwise agreed by the Director and shall be submitted at the same time as the hard copies.

2 Special Conditions

2.1 [Not Used]

2.2 [Not Used]

Environmental Project Committee (ENPC)

- 2.3 To oversee and facilitate effective control of the cumulative environmental impacts arising from potential multiple contracts for the construction of the entire Wan Chai Development Phase II (WDII) and Central-Wan Chai Bypass (CWB) (hereafter referred to as the whole Project), the Permit Holder shall take part as a member of Environmental Project Committee (ENPC) set up for the whole project (see note 8).

The ENPC shall make recommendation to enhance the monitoring and audit of the environmental performance of the whole project and other relevant nearby projects on top of requirements as set out in Conditions 3.1 to 4.2 of this Permit or corresponding set out under subsequent Environmental Permits issued for the whole project and other relevant nearby projects (see notes 7 and 8).

2.4 [Not Used]

2.5 [Not Used]

2.6 [Not Used]



2.7 [Not Used]

2.8 [Not Used]

Measures to Mitigate Construction Noise Impact

2.9 To mitigate construction noise impact, the Permit Holder shall deposit with the Director, at least two weeks prior to the commencement of construction of the corresponding component(s) of the Project, four hard copies and one electronic copy of the construction noise management plan, consisting of layout plan(s) in the scale of 1:1,000 or other appropriate scale and explanatory statement(s) showing the noise mitigation measures to include the use of movable/temporary noise barriers, the use of quiet powered mechanical equipments and the adoption of multiple-phase construction schedules, where appropriate. The submission(s) shall be certified by the ET Leader and verified by the IEC as conforming to the relevant information and recommendations contained in the approved CWB&IECL EIA Report (Register No. AEIAR-041/2001) and the WDII&CWB EIA Report (Register No. AEIAR-125/2008) before deposit with the Director. All measures recommended in the finalised submission(s) under this Condition shall be fully and properly implemented. Measures covered by other pollution control Ordinances shall not be included in this construction noise management plan. (see note 8)

2.10 [Not Used]

2.11 [Not Used]

2.12 [Not Used]

2.13 [Not Used]

Measures to Mitigate Landscape and Visual Impact

2.14 To reduce the landscape and visual impact during construction stage of the Project, the Permit Holder shall implement a series of landscape and visual mitigation measures. The Permit Holder shall, at least one month before the commencement of corresponding parts of landscape works of the Project, deposit with the Director four hard copies and one electronic copy of landscape plan(s). The landscape plan(s) shall show the design details, locations, implementation programme, maintenance and management schedules, and drawings in the scale of 1:1,000 or other appropriate scale of the landscape and visual mitigation measures of the Project. Before submission to the Director, the landscape plan(s) shall be certified by the ET Leader and verified by the IEC as conforming to the relevant information and recommendations contained in the approved CWB&IECL EIA Report (Register No. AEIAR-041/2001) and the WDII&CWB EIA Report (Register No. AEIAR-125/2008). All measures recommended in the finalised submission(s) under this Condition shall be fully and properly implemented. (see note 8)

3 Environmental Monitoring and Audit Requirements

3.1 The EM&A programme shall be implemented in accordance with the procedures and requirements as set out in the updated EM&A Manual approved for the CWB project (See note 8) Any major changes to the programme shall be justified by the ET Leader and verified by the IEC employed for the CWB project (see note 7) as conforming to the information and requirements contained in the



updated EM&A Manual.

- 3.2 Samples, measurements and necessary remedial actions shall be taken in accordance with the requirements of the updated EM&A Manual for the CWB project (note 8) by:
- conducting baseline environmental monitoring;
 - conducting impact monitoring;
 - carrying out remedial actions described in Event/Action Plans of the updated EM&A Manual in accordance with the time frames set out in Event/Action Plans, or as agreed by the Director, in case where specified criteria in the updated EM&A Manual approved are exceeded; and
 - logging and keeping records of details of (a) to (c) above for all parameters within 3 working days of collection of data or completion of remedial action(s), for the purpose of preparing and submitting the monthly EM&A Reports and to make available for inspection on site.
- 3.3 [Not Used].
- 3.4 Four hard copies and one electronic copy of monthly EM&A Report shall be submitted to the Director within 10 working days after the end of each reporting month. The EM&A Reports shall include a summary of all non-compliance (exceedances) of the environmental quality performance limits (Action and Limit Levels). In compiling this monthly EM&A Report, all relevant cumulative construction impacts due to concurrent activities of the concurrent projects including the Central Reclamation Phase III and the Wan Chai Development Phase II projects shall be addressed. The submissions shall be verified by the IEC employed for the CWB project (see note 8). Additional copies of the submission shall be provided to the Director upon request by the Director.
- 3.5 All environmental monitoring and audit data submitted under this Permit shall be true, valid and correct.

4 Electronic Reporting of EM&A Information

- 4.1 To facilitate public inspection of the Baseline Monitoring Report and regular EM&A Reports via the EIAO Internet Website and at the EIAO Register Office, electronic copies of these Reports shall be prepared in Hyper Text Markup Language (HTML) (version 4.0 or later) and in Portable Document Format (PDF version 4.0 or later), unless otherwise agreed by the Director and shall be submitted at the same time as the hardcopies as described in Conditions 3.3 and 3.4 of this Permit. For the HTML version, a content page capable of providing hyperlink to each section and sub-section of these Reports shall be included in the beginning of the document. Hyperlinks to all figures, drawings and tables in these Reports shall be provided in the main text from where the respective references are made. All graphics in these Reports shall be in interlaced GIF format unless otherwise agreed by the Director. The content of the electronic copies of these Reports must be the same as the hardcopies.
- 4.2 All environmental monitoring data described in Condition 4.1 above shall be made available to the public via a dedicated web site to be set up for the CWB project (see note 9) in the shortest practicable time and in no event later than two weeks after the relevant environmental monitoring data are collected or become available, unless otherwise agreed with the Director.

Notes :

- This Permit consists of three parts, namely, PART A (Main Permit), PART B (Description of Designated Project) and PART C (Permit Conditions). Any person relying on this permit should obtain

independent legal advice on the legal implications under the Ordinance, and the following notes are for general information only.

2. If there is a breach of any conditions of this Permit, the Director or his authorized officer may, with the consent of the Secretary for the Environment, order the cessation of associated work until the remedial action is taken in respect of the resultant environmental damage, and in that case the Permit Holder shall not carry out any associated works without the permission of the Director or his authorized officer.
3. The Permit Holder may apply under Section 13 of the Ordinance to the Director for a variation of the conditions of this Permit. The Permit Holder shall replace the original permit displayed on the construction site by the amended permit.
4. A person who assumes the responsibility for the whole or a part of the designated project(s) may, before he assumes responsibility of the designated project(s), apply under Section 12 of the Ordinance to the Director for a further environmental permit.
5. Under Section 14 of the Ordinance, the Director may with the consent of the Secretary for the Environment, suspend, vary or cancel this Permit. The suspended, varied or cancelled Permit shall be removed from display at the construction site.
6. If this Permit is cancelled or surrendered during construction of the Project, another environmental permit must be obtained under the Ordinance before the Project could be continued. It is an offence under section 26(1) of the Ordinance to construct or operate a designated project listed in Part I of schedule 2 of the Ordinance without a valid environmental permit.
7. Highways Department (HyD), the Holder of Environmental Permit (EP) No. EP-364/2009, is required under EP-364/2009, or any subsequent EP amended by the Director under the Ordinance:
 - (i) to establish an Environmental Team (ET) which shall be headed by an ET Leader;
 - (ii) to employ an Independent Environmental Checker (IEC);
 - (iii) to liaise with the Holder of Environmental Permit No. EP-356/2009 on to jointly set up an Environmental Project Committee (ENPC); and
 - (iv) to liaise with the Holder of Environmental Permit No. EP-356/2009 to jointly set up a Community Liaison Group (CLG),
for the CWB project.
8. HyD, the Holder of EP-364/2009 is required under EP-364/2009, or any subsequent EP amended by the Director under the Ordinance:
 - (i) to notify the Director in writing the commencement date of construction of the CWB project;
 - (ii) to notify the Director the date of setting up the ENPC;
 - (iii) to notify the Director the date of setting up the CLG;
 - (iv) to submit to the Director for approval the updated Environmental Monitoring and Audit Manual (updated EM&A Manual);
 - (v) to inform the Director in writing the management organization of the main construction companies and/or any form of joint ventures associated with the construction of the CWB project;
 - (vi) to deposit with the Director a detailed works schedule and location plans;
 - (vii) to deposit with the Director a construction noise management plan;
 - (viii) to deposit with the Director an operational air quality management plan;
 - (ix) to deposit with the Director landscape plan(s);
 - (x) to deposit with the Director an additional mitigation plan for Slip Road 8;
 - (xi) to submit to the Director the Baseline Monitoring Report; and
 - (xii) to submit to the Director the monthly EM&A Reports,
for the CWB project.



9. HyD, the Holder of Environmental Permit EP-364/2009, is required under EP-364/2009, or any subsequent EP amended by the Director under the Ordinance:
- (i) to implement the proposed construction works of CWB including its Road Tunnel and Slip Roads, ventilation buildings and vent shaft(s) at the location shown in Figure 1 of EP-364/2009 together with the relevant environmental mitigation measures; and
 - (ii) to set up a dedicated web site and notify the Director in writing the Internet address where the environmental monitoring and project data is to be placed, for the CWB project.
10. Any person who constructs the Project contrary to the conditions in the Permit, and is convicted of an offence under the Ordinance, is liable:-
- (i) on a first conviction on indictment to a fine of \$ 2 million and to imprisonment for 6 months;
 - (ii) on a second or subsequent conviction on indictment to a fine of \$ 5 million and to imprisonment for 2 years;
 - (iii) on a first summary conviction to a fine at level 6 and to imprisonment for 6 months;
 - (iv) on a second or subsequent summary conviction to a fine of \$1 million and to imprisonment for 1 year; and
 - (v) in any case where the offence is of a continuing nature, the court or magistrate may impose a fine of \$ 10,000 for each day on which he is satisfied the offence continued
11. The Permit Holder may appeal against any condition of this Permit under Section 17 of the Ordinance within 30 days of receipt of this Permit.
12. The Notes are for general reference only and that the Permit Holder should refer to the EIA Ordinance for details and seek independent legal advice.

Environmental Permit No. FEP-09/364/2009/B
環境許可證編號 FEP-09/364/2009/B



Table 1a:

[Not used]

Table 1b Exhaust Related Design Criteria of the Central Ventilation Building and the East Ventilation Building and its Vent Shaft (based on Table 3.11 of the WDII&CWB EIA Report (Register No. AEIAR-125/2008))*

	Cross-sectional area of stack (m ²)	Exit velocity (m s ⁻¹)	Minimum mid-discharge height (meter above ground)	Exhaust direction
Central Ventilation Building (CVB)**	219	8	17.5	Vertical
Vent shaft of the East Ventilation Building (EVB)***	94	8	16.25	Inclined 45 degree upward (discharge towards sea direction)

Notes: * This Table shall be read in conjunction with Condition 2.13 and Figure 1 of this Permit.
 ** The vent shaft of CVB will be incorporated within the CVB.
 *** The vent shaft of EVB will be separated from the EVB and located at the eastern breakwater of the Causeway Bay Typhoon Shelter.



COVERED BY APPROVED CWB & IECL EIA REPORT
(EIA REGISTER NO. AEIAR - 041/2001)
包括在已獲批准的 CWB & IECL 環評報告中 (登記冊編號: AEIAR-041/2001)

COVERED BY APPROVED WDII & CWB EIA REPORT
(EIA REGISTER NO. AEIAR - 125/2008)
包括在已獲批准的 WDII & CWB 環評報告中
(登記冊編號: AEIAR-125/2008)

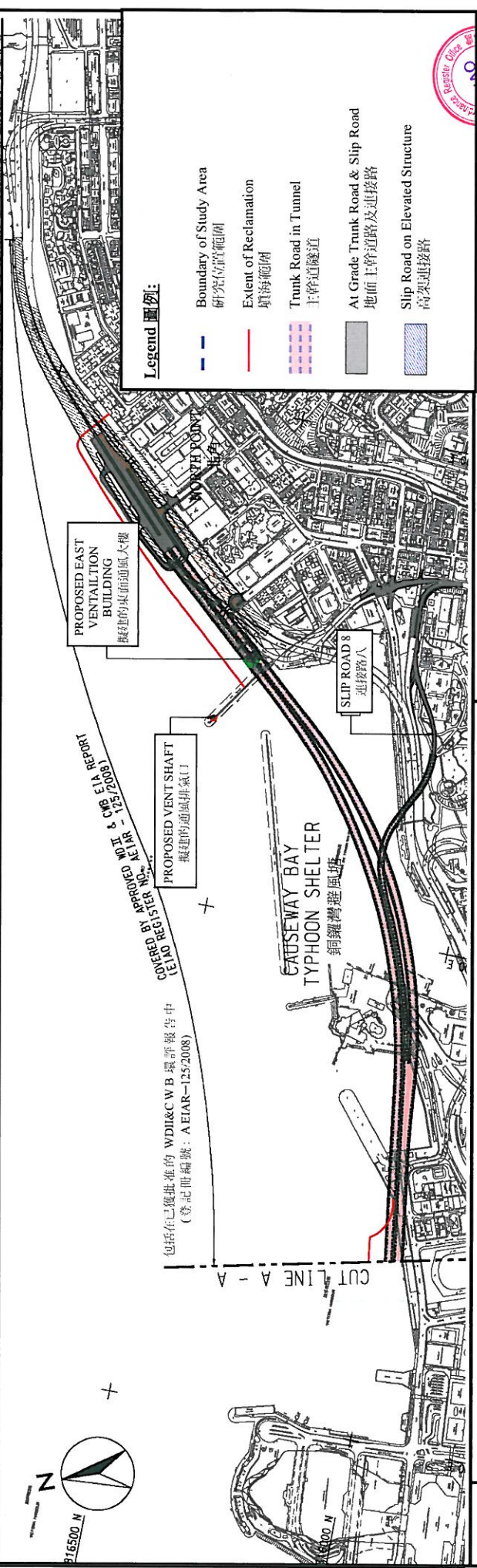
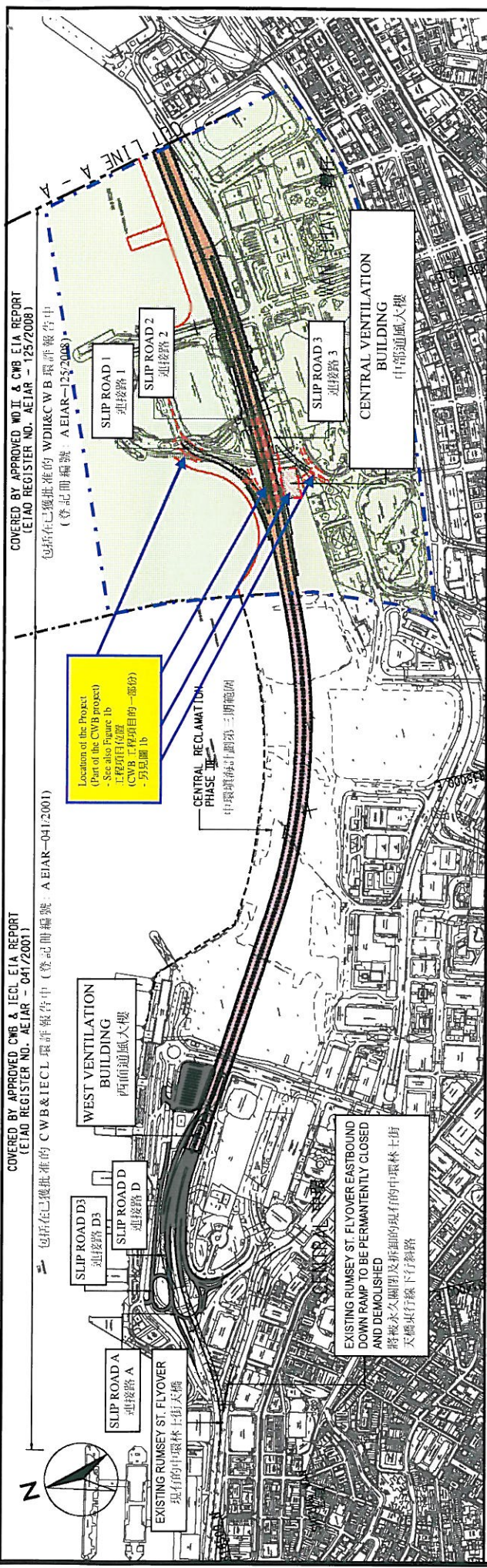

Figure 1a : Location of the Project
圖 1a : 工程項目位置

(This figure was prepared based on Figure 1a of Application for Further Environmental Permit (Application No.: FEP-144/2013))
(本圖是根據申請新的環境許可證 (申請書編號: FEP-144/2013) 圖 1a 編製)

Project Title: Wan Chai Development Phase II - Central-Wan Chai Bypass at Wan Chai
West (Contract No. HY/2012/08) - Tunnel Works
工程項目名稱: 灣仔發展第二期 - 中環灣仔繞道 - 灣仔西段 (合約編號 HK/2012/08) - 隧道工程

Environmental Permit No. : FEP-09-364/2009/A
環境許可證編號 : FEP-09-364/2009/A

Legend 圖例:

- Boundary of Study Area 研究區範圍
- Extent of Reclamation 填海範圍
- Trunk Road in Tunnel 主幹道隧道
- At Grade Trunk Road & Slip Road 地面主幹道及連接路
- Slip Road on Elevated Structure 高架連接路



Legend 圖例:

■ SITE BOUNDARY

KEY PLAN
SCALE: 1:5000

VICTORIA HARBOUR

60041297/C3/100/1002

60041297/C3/102/1001

Slip Road 3

Middle Ventilation Building substructure

Slip Road 1

CWB tunnel

AECOM

Fig 1b

DATE	BY	CHKD	APPD
11/03/13	ST	ST	ST
11/03/13	ST	ST	ST
11/03/13	ST	ST	ST

Figure 1b : General Layout of the Project

圖 1b : 工程項目佈局圖

(This figure was prepared based on Figure 1b of Application for Further Environmental Permit (Application No.: FEP-144/2013))

(本圖是根據申請新的環境許可證 (申請書編號 FEP-144/2013) 圖 b 編製)

Project Title: Wan Chai Development Phase II - Central-Wan Chai Bypass at Wan Chai West

(Contract No. HY/2012/08) - Tunnel Works

工程項目名稱: 灣仔發展第二期 - 中環灣仔繞道 - 灣仔西段 (合約編號 HK/2012/08) - 隧道工程

Environmental Permit No.: FEP-09-364/2009/B

環境許可證編號 : FEP-09-364/2009/B

